

STRATA PLAN OF:  
 LOT 3, DISTRICT LOT 23G,  
 WELLINGTON DISTRICT, PLAN 19319.  
 EXCEPT PART IN STRATA PLAN EPS1119 (PHASE 1 AND 2).  
 BCGS 92F 030

STRATA PLAN EPS1119  
 PHASE 3  
 Sheet 1 of 6

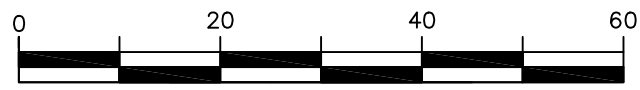

The intended plot size of this plan is 560mm in height by 432mm in width (C Size) when plotted at a scale of 1:750.

Integrated Survey Area No. 20, City of Nanaimo, NAD83 (CSRS) 3.0.0.BC.1.NVI.  
 Grid bearings are derived from observations between geodetic control monuments 79H9187 & 79H9188.

The UTM coordinates and estimated horizontal positional accuracy are derived from the MASCOT published coordinates and standard deviations for geodetic control monuments 79H9187 & 79H9188.

This plan shows horizontal ground-level distances unless otherwise specified. To compute grid distances, multiply ground-level distances by the average combined factor of 0.9996554 which has been derived from geodetic control monuments 79H9187 & 79H9188.

**Legend**

- Denotes Standard Iron Post Found
- ⬇ Denotes Aluminum Post Found
- ⊙ Denotes Control Monument Found
- SL Denotes Strata Lot
- Pt. Denotes Part
- LCP Denotes Limited Common Property
- (C) Denotes Common Property
- Sq.m. Denotes Square Metres

**Civic Address**

6057 Doumont Road

The buildings included in this strata plan have not been previously occupied.

The buildings shown hereon are within the external boundaries of the land that is the subject of the strata plan.

GCM No. 347724  
 Tablet Marking: 79H9188  
 Datum: NAD83(CSRS)(1997) 3.0.0.BC.1.NVI  
 UTM Zone 10  
 UTM Northing: 5452929.75  
 UTM Easting: 424072.36  
 Point Scale Factor: 0.9996553  
 Estimated horizontal positional accuracy: 0.02 metres



GCM No. 977801  
 Tablet Marking: 79H9187  
 Datum: NAD83(CSRS)(1997) 3.0.0.BC.1.NVI  
 UTM Zone 10  
 UTM Northing: 5452757.95  
 UTM Easting: 424118.10  
 Point Scale Factor: 0.9996555  
 Estimated horizontal positional accuracy: 0.02 metres



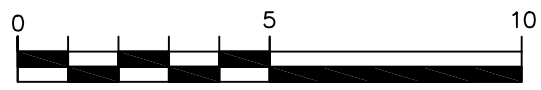

The intended plot size of this plan is 560mm in height by 432mm in width (C Size) when plotted at a scale of 1:150.

Angles of building walls deflect by multiples of 45 degrees, unless otherwise noted.

All balconies and patios are defined as to height by the centre of the floor above or its extensions, or where there is no floor above by the average height of a strata lot within the same building, unless otherwise noted.

Section arrows on this plan point in direction of view.

This sheet shows dimensions to the centerline of building walls.

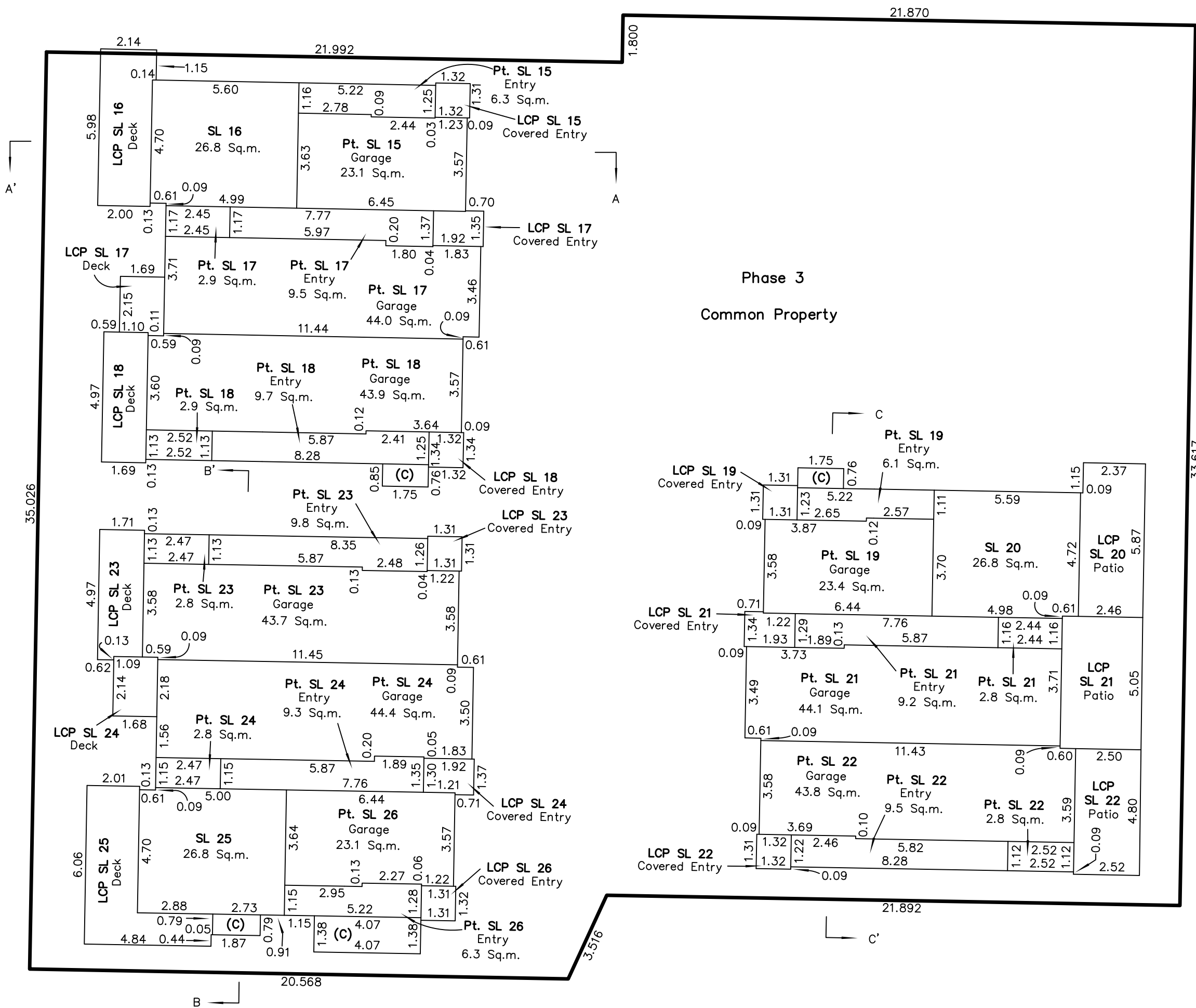

SECOND LEVEL

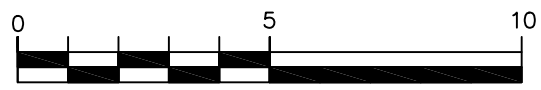

The intended plot size of this plan is 560mm in height by 432mm in width (C Size) when plotted at a scale of 1:150.

Angles of building walls deflect by multiples of 45 degrees, unless otherwise noted.

All balconies and patios are defined as to height by the centre of the floor above or its extensions, or where there is no floor above by the average height of a strata lot within the same building, unless otherwise noted.

Section arrows on this plan point in direction of view.

This sheet shows dimensions to the centerline of building walls.

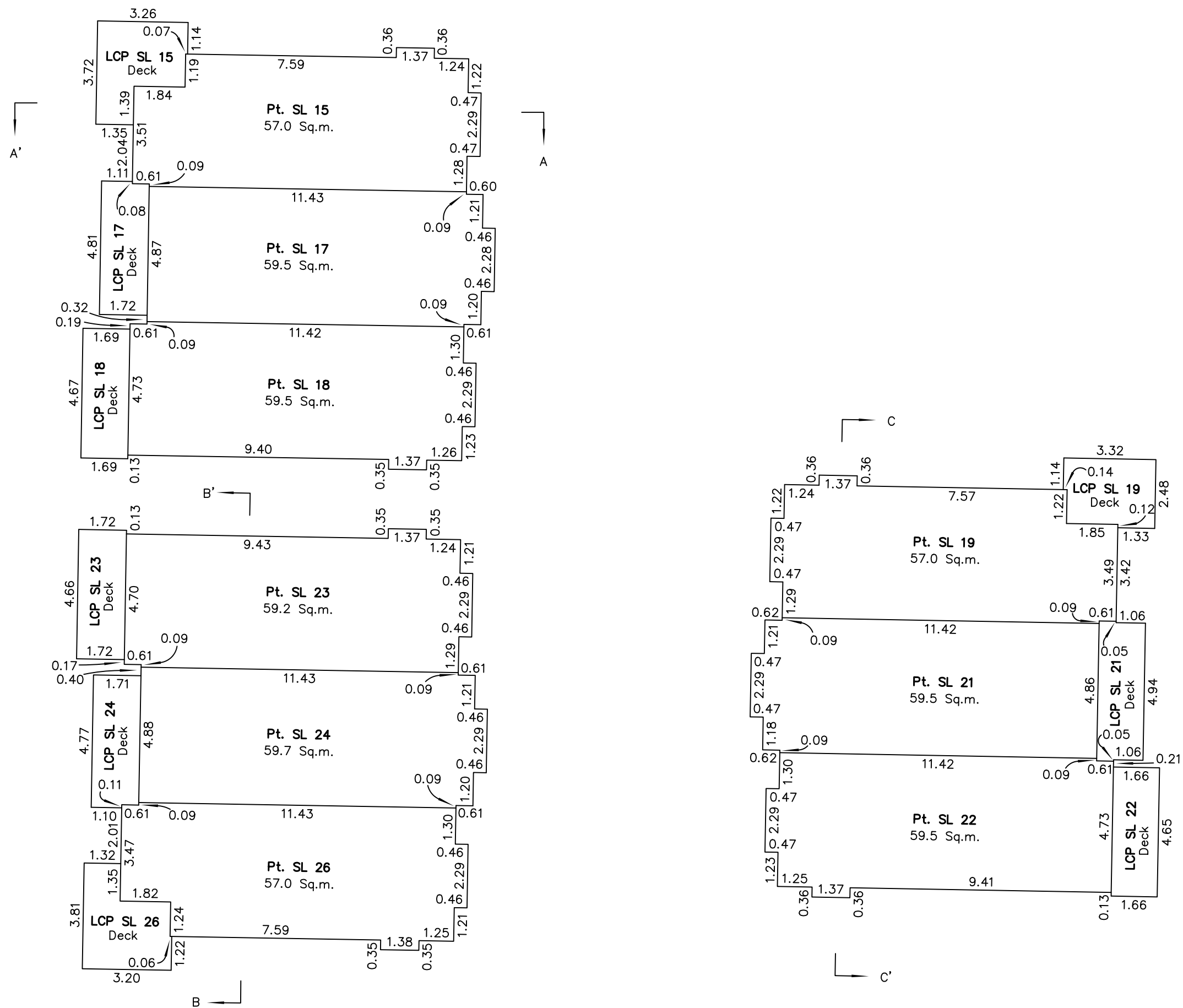

THIRD LEVEL

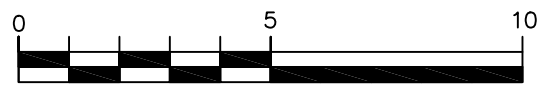

The intended plot size of this plan is 560mm in height by 432mm in width (C Size) when plotted at a scale of 1:150.

Angles of building walls deflect by multiples of 45 degrees, unless otherwise noted.

All balconies and patios are defined as to height by the centre of the floor above or its extensions, or where there is no floor above by the average height of a strata lot within the same building, unless otherwise noted.

Section arrows on this plan point in direction of view.

This sheet shows dimensions to the centerline of building walls.

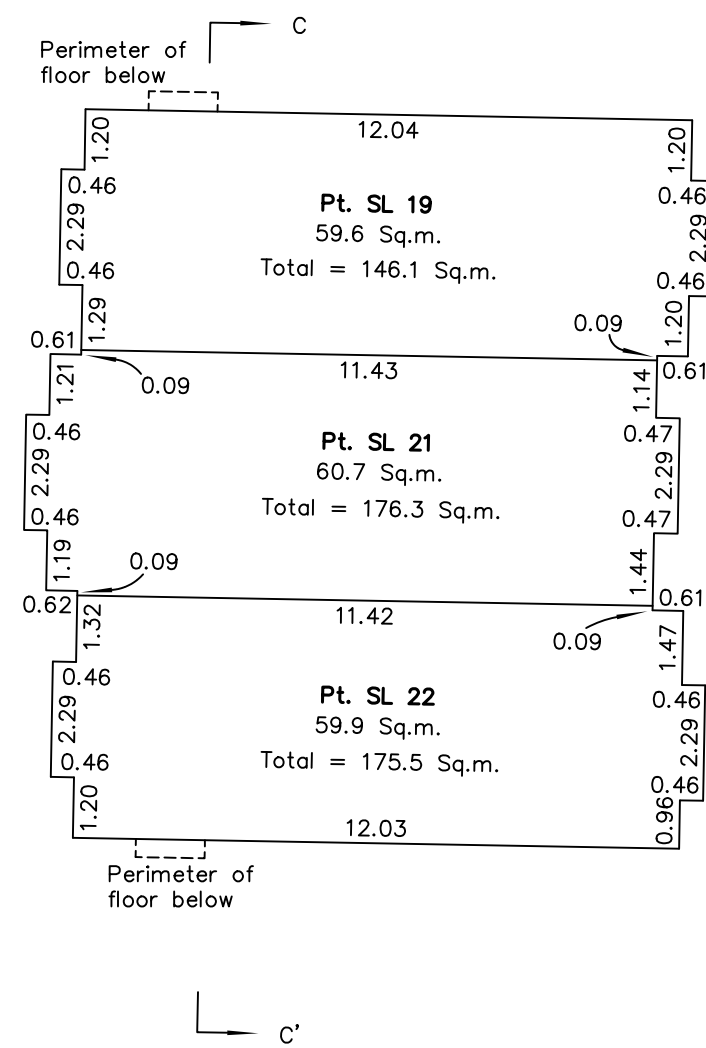
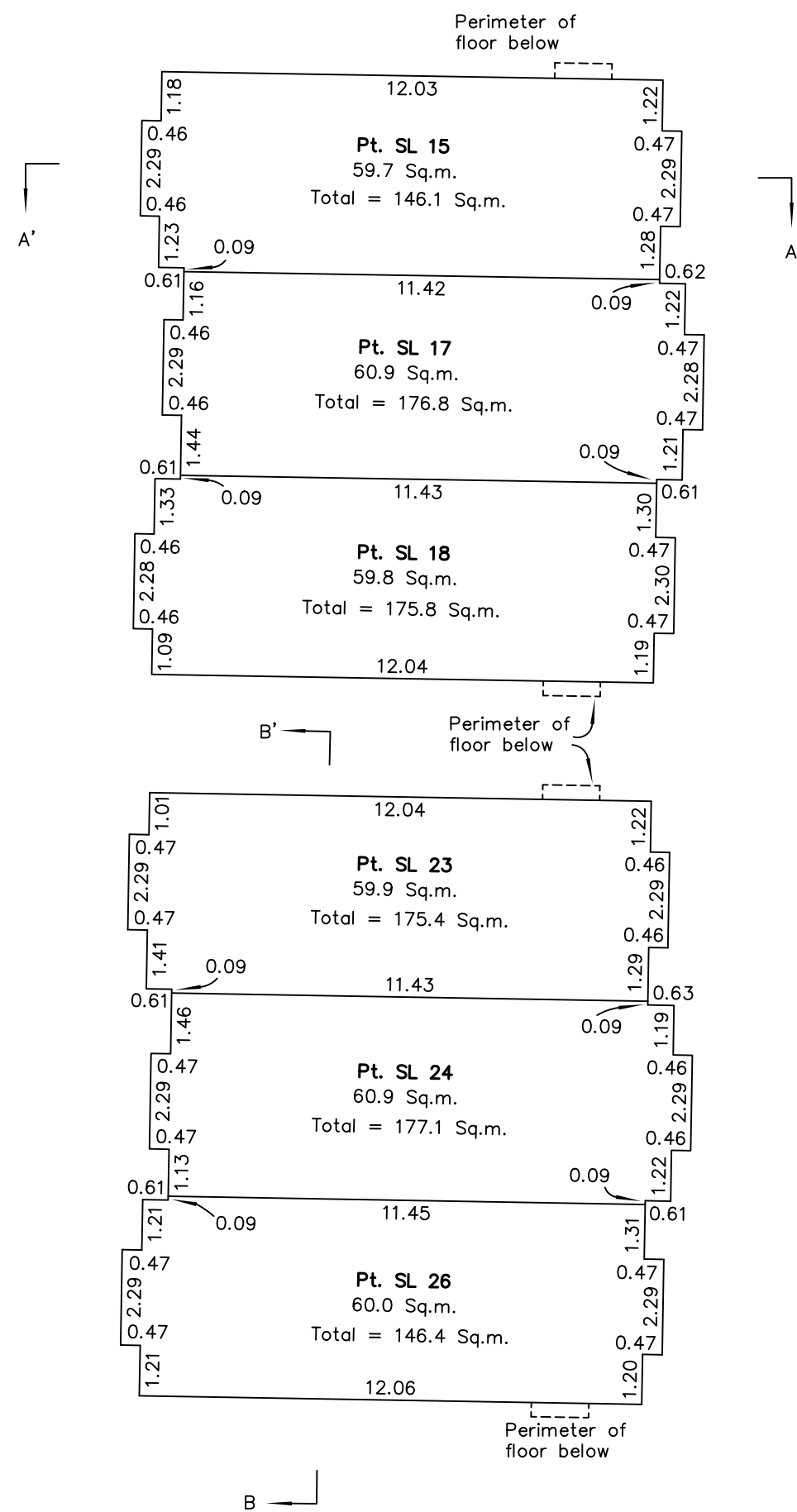

CROSS SECTIONS

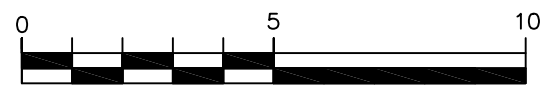

The intended plot size of this plan is 560mm in height by 432mm in width (C Size) when plotted at a scale of 1:150.

All balconies and patios are defined as to height by the centre of the floor above or its extensions, or where there is no floor above by the average height of a strata lot within the same building, unless otherwise noted.

Section A-A'  
Building 5

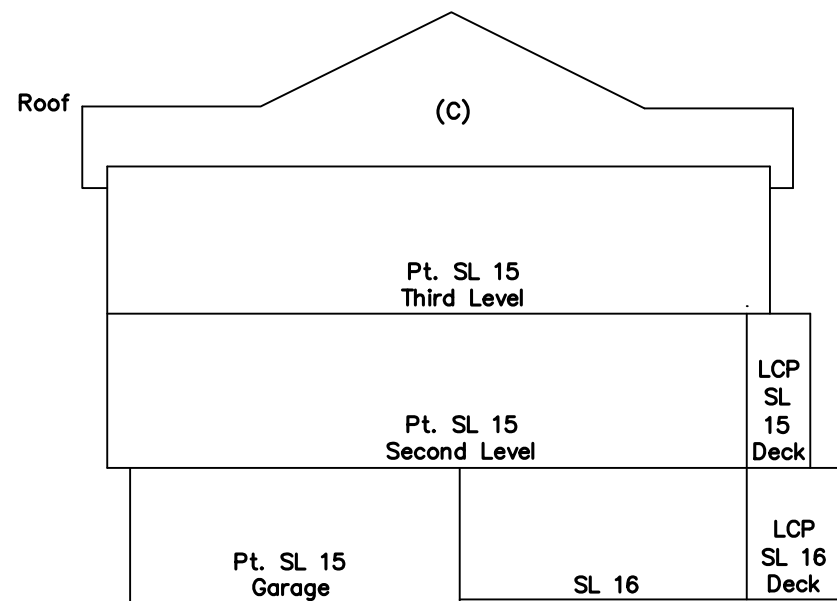

Section B-B'  
Building 8

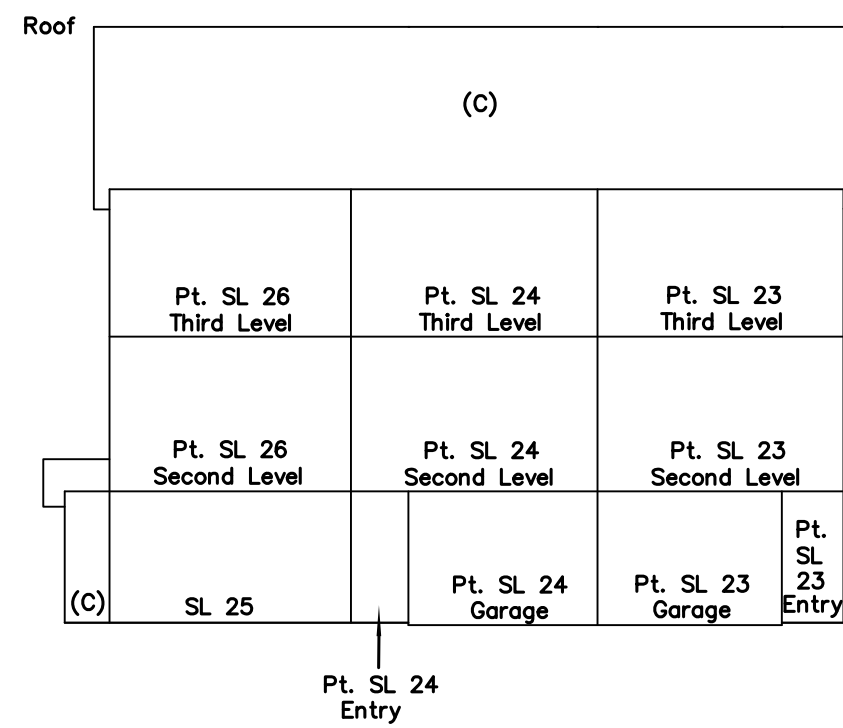

Section C-C'  
Building 7

